

# UA860

## Fingerprint Time & Attendance and Access Control Terminal



UA860 is a 2.8-inch color screen biometric terminal for Time & Attendance, and Access Control (primary) applications. It adopts BioID fingerprint collector for excellent recognition and internal WiFi for convenient communication. Users can manage data via TCP/IP, WiFi, and USB host port for data up/download to avoid the risk of accidental deletion. Besides, optional ADMS can achieve remote data management with our ZKTime. Net 3.0.

---

## Features

- **Wi-Fi:** WiFi module is integrated. It is working on the 2.4G radio band, and meet the IEEE 802.11b/g standards.
- **USB:** Support USB host connection to achieve data backup and management while the device is standalone.
- **ADMS:** Optional for devices worldwide using. Solve the device's capacity limitation through networking via HTTP sever. Mondial devices can be connected and upload & backup data automatically. This is helpful for devices managing and monitoring.
- **BioID:** Using BioID Fingerprint Collector for excellent recognition rate. Dry, moist, or rough fingerprints can work well.

# Specifications

User Capacity	3,000
Fingerprint Capacity	3,000
Card Capacity	3,000
Record Capacity	50,000
Display	2.8" color screen
Communication	TCP/IP, WiFi, USB-host
Standard Functions	14-digit User ID, T9 Input, SMS, DST, Self-Service Query, Automatic Status Switch, Schedule Bell, Workcode, Multiple Verify Modes, RS232 External Printer
Optional Functions	IC/ID, Webserver, ADMS, Backup Battery, SilkID Fingerprint Collector
Access Control Interface	3rd Party Electric Lock, Exit Button
Software	ZKTime.Net 3.0, ZKBio Time
Power Supply	DC 12V/1.5A
Dimension	185 * 137 * 38.2mm (LxWxT)
Operating Temp.	0 °C - 45 °C
Operating Humidity	20% - 80%

## Configuration

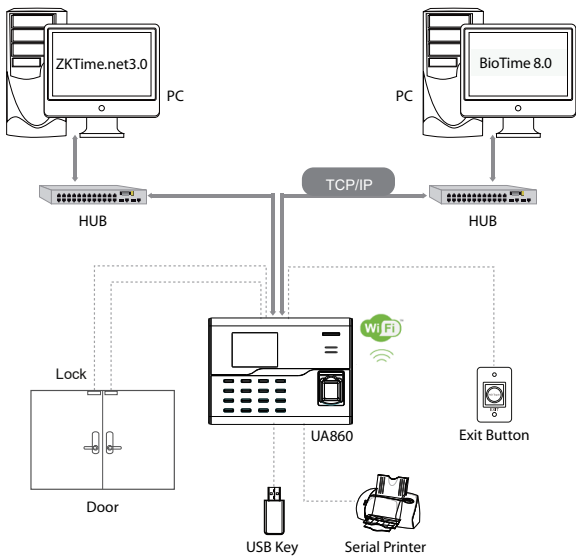

## Interface

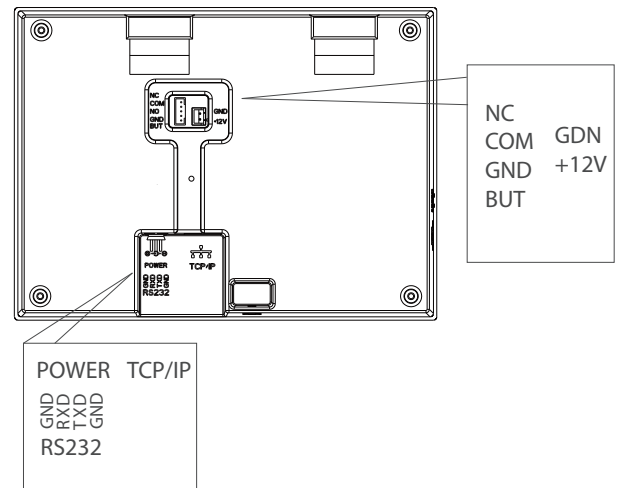

## What's in the Box

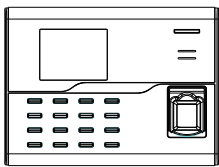

UA860

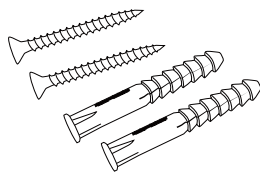

Screws and Holders

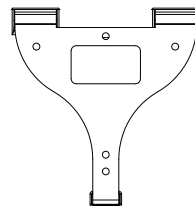

Back Plate

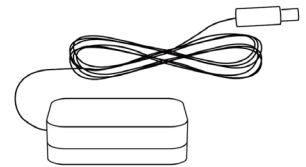

Power Adapter

